

# Equipotential Socket



wandsworth

GROUP

## Standards, Approvals & Directives

In accordance with DIN 42801 Part 2

## Description

The Equipotential socket has been designed for additional potential equalisation within medical environments.

The purpose of the socket is to equalise potentials between different metal parts that can be touched simultaneously, or to reduce difference of potential which can occur during operation between the bodies of medical electrical devices and conductive parts of other objects.



## Features

- MEIGaN Compliant
- Prevents significant touch voltages.
- Tight push fit for ease of operation
- No special tool required for removal.

## Applications/Uses

The use of the high quality Equipotential socket ensure dependable potential equalization in places where its particular important. Eg. Hospital Facilities and Medical Practices.

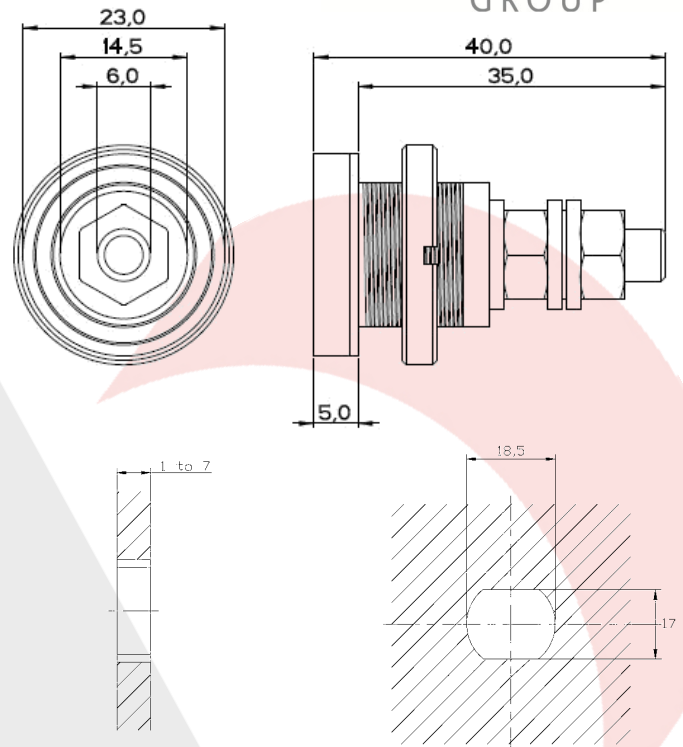

Drilling Guide Side View

Drilling Guide

## Compatibility

The Equipotential socket is compatible with potential equalization leads.

The Equipotential Socket is a black panel receptacle with a green/yellow coloured ring and stainless steel pin.

## Ordering:

When ordering, please state the catalogue number of the socket.

Please see Wandsworth Catalogue for further information.

**Catalogue number:**

**EP01**

Tel: +44(0)1483 713 400

Email: [sales@wandsworthgroup.com](mailto:sales@wandsworthgroup.com)